

Hassas CNC İnce Çaplı Döner Punta

Precision CNC Slim Size Live Center

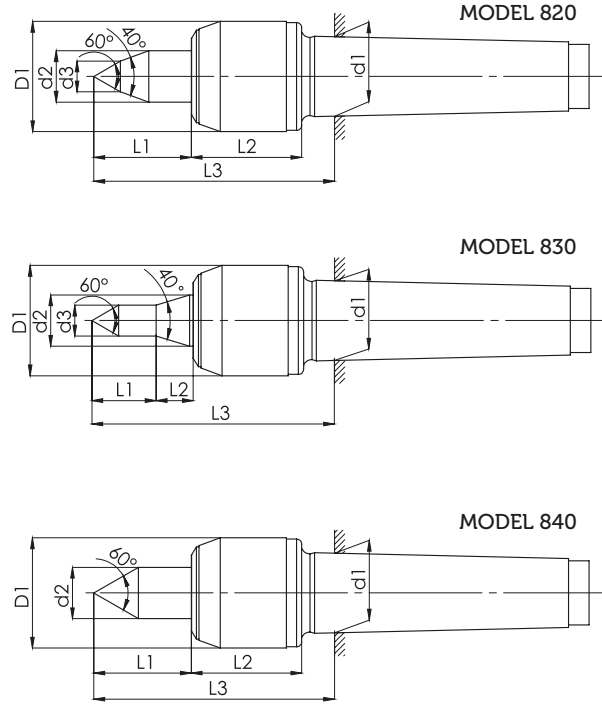

MODEL		820		830		840	
Mors Koniği / Morse conic	MK	4	5	4	5	4	5
Ölçüler mm Dimensions mm	D1	43	60	43	60	43	60
	d1	31.267	44.399	31.267	44.399	31.267	44.399
	d2	20	30	20	30	20	30
	d3	12	14	12	14	-	-
	L1	30	50	25	25	27	40
	L2	88	62	15	27	42	60
	L3	88	123	95	133	88	118
Uç Salgısı / Center Runout	Max	0,005	0,005	0,005	0,005	0,005	0,005
Ağırlık / Weight	kg.	1,2	3	1,2	3	1,2	3
Sipariş Kodu / Order Code		C110	C140	C120	C150	C130	C160

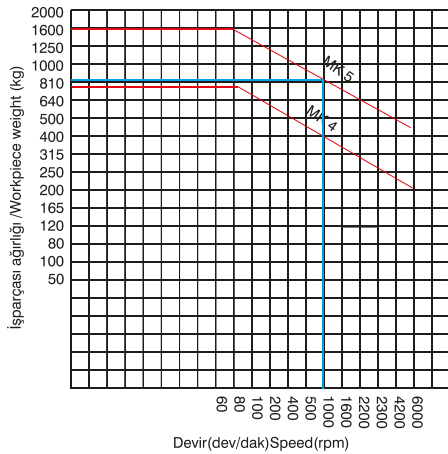

Örnek: 1000 Dev/Dak. ile dönen MK5 puntanın taşıya bileceği yük değeri
Radyal yük: 820 kg
eksenel yük: 480 daN

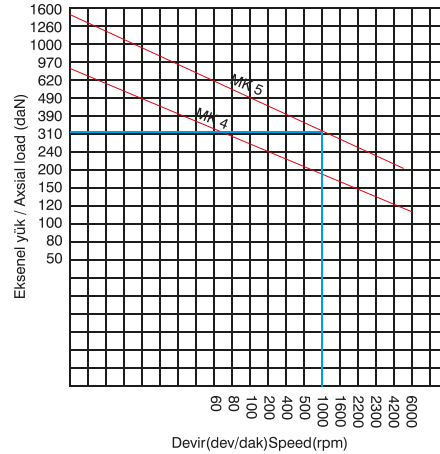

Example: load value that rotary MK5 center cold carry with 1000 revolution /min
Radial load: 820 Kg
Axial load: 480 daN